

Wedge Grips – 50 kN



Tensile Rating: 50kN (12,000 lbs.)

Sample Thickness: (Depends on jaw inserts – See Below)

Weight per grip: 6.75kg without jaws.

Temperature Range: 0 to 130 Celsius (standard) or -70 to +280 C.

Adapter/Coupling: female 1 1/4" with 1/2" locking pin

Schematic (mm)

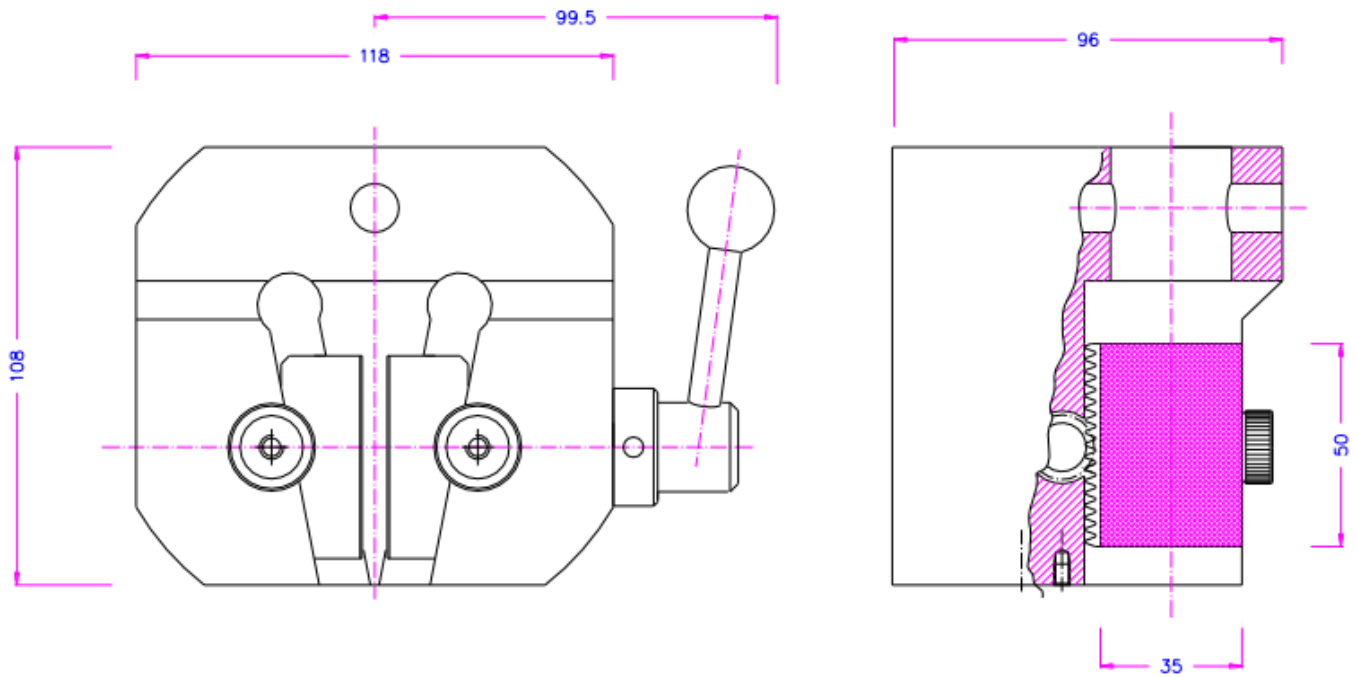

Jaw Inserts

Surface	Clamping surface H x W	Opening	Weight per pair
Pyramid (serrated) jaws	50 x 35mm	0 - 13mm	0.48 kg
Pyramid (serrated) jaws	50 x 35mm	4 - 16mm	0.41 kg
V-jaws	Clamping height 50mm	3 - 13mm Ø	0.46 kg
V-jaws	Clamping height 50mm	4 - 16mm Ø	0.41 kg
V-jaws	Clamping height 50mm	10 - 20mm Ø	0.35kg