

TENSILE STRENGTH TEST FIXTURES

to test tension and tensile adhesion properties perpendicular to surface according to ASTM C297, ASTM D1623B, ASTM D1037 (Fig. 8), DIN 52365, EN 319, EN 1607, EN 12004.

Max. load:	20 kN
Coupling:	Af159 or Af20. Further couplings on request.
Carrier and inserts:	Aluminium, anodized
Cardan adapter:	Steel, nickel-plated
Temperature range:	0 ... +70°C
Scope of supply:	1 pair of carriers* Inserts have to be ordered separately

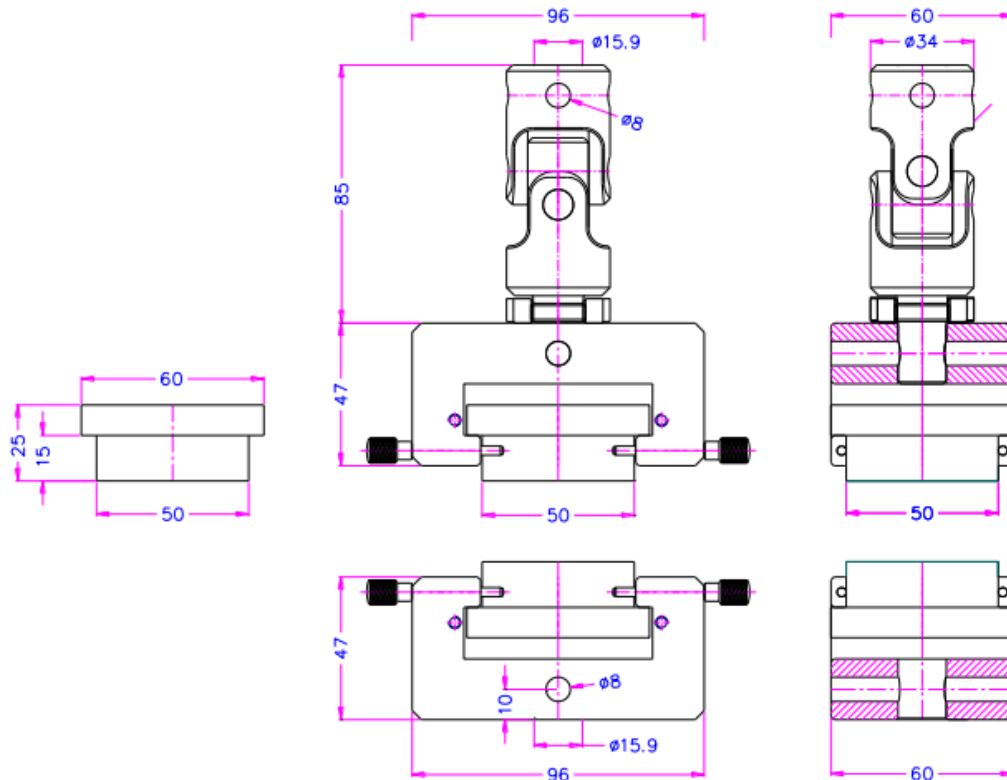

***Measurements may differ slightly based on block insert sizes**